

# SHARP

## ER-A280F ER-A280N

Electronic Cash Register



ER-A280N

Working Smart—  
There's No Better Way  
to Grow a Business

- Large, easy-to-view multi-line LCD operator display (192 x 80 dots) with tilt mechanism
- Standard SD card slot for data backup
- 4 built-in RS232 ports for system expansion
- 2,000 standard PLUs, expandable to 16,000



ER-A280F

## Large Multi-Line LCD for User-Friendly Operation

The backlit, six- or 10-line\*, 192 x 80-dot LCD operator display featured on the ER-A280F/A280N provides high visibility. It can display up to 24 alphanumeric characters, allowing clerks to view items, prices, and other information even in low-light environments. And for better viewing, the operator display can be tilted to an angle. The ER-A280F/A280N also features an easy-to-read, 10-digit LED customer display that ensures customer confidence.

\* Six lines for sales registration, 10 lines for reporting/programming

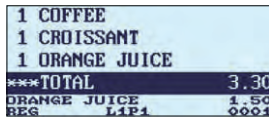

Operator display



Customer display

## Scanner-Ready and On-Line Capability with Four RS232 Interface Ports

The ER-A280F/A280N comes standard with four RS232 interface ports for system expansion, making it easy to upload sales figures to a PC for efficient data management and analysis. An optional scanner can also be connected for the added advantage of speedy, accurate barcode entry.



## Data Backup with SD Card Slot

The ER-A280F/A280N is equipped with an SD card slot. SD cards can be used to back up various kinds of data, including daily sales and Electronic Journal data.

Note: SD cards are not included. Consult your Sharp dealer for details.

The SD logo is a trademark of the SD Card Association.



## Electronic Journal

The ER-A280F/A280N features an Electronic Journal function that can store up to 9,000 lines of transaction data electronically, thus helping to conserve paper and reduce costs. And for easy reference, the Electronic Journal View function displays transaction data from previous entries.

## Specifications

Model		ER-A280F	ER-A280N
Display	Operator	Monochrome LCD with backlight 192 x 80 dots	
	Customer	10-digit, 7-segment LED	
Printer	Type	1-station, drop-in, thermal	
	Digits	30 digits	
	Paper width	58 mm	
	Speed	Approx. 15 lines/sec.	
Drawer	Bill	3 compartments	
	Coin	7 compartments	
Keyboard	Type	Flat key	Normal key
	No. of keys	70	51
Interface	Four RS232 ports (2 x 9-pin D-sub, 2 x RJ45) One SD card slot		
Departments	Standard	6	12
	Max.	99, 14 groups	
PLUs	Standard 2,000, max. 16,000		
Electronic journal	9,000 lines*		
VAT/tax system	Total 6 rates		
Dimensions (W x D x H) (approx.)	330 x 365 x 225 mm		
Weight (approx.)	9 kg		

\* Will be less than 9,000 when using 16,000 PLUs.

## Quick Thermal Printer with Graphic Logo Printing

Featuring thermal printing technology, the ER-A280F/A280N prints out sales receipts on 58-mm-wide paper at a speedy rate of approximately 15 lines per second. Graphic logos can be printed out as well, helping to further promote your business. Plus, the drop-in paper loading mechanism allows you to change paper rolls quickly and easily.



## Quick and Accurate Price Entry

Equipped with 2,000 PLUs (price look-ups), expandable to 16,000, the ER-A280F/A280N makes entering pricing information a snap. By simply entering the code for the items being purchased, you can total up sales with accuracy and speed. A total of 99 departments are also available, enabling you to easily track and analyse transactions by product type.

## Other Key Features

- Flat keyboard (ER-A280F) or normal keyboard (ER-A280N)
- 2,000 standard PLUs/EANs (2 price levels), expandable to 16,000 (1 price level)
- Promotion functionality allows up to 30 tables (free item/amount or discount %)
- Drawer (3 bill and 7 coin compartments)
- Up to 99 code-entry clerk keys (20 standard)
- Overlapped clerk system
- Simple GLU (guest look-up) function
- 10 automatic keys
- Tax (VAT) shift function (6 rates)

## System Configuration

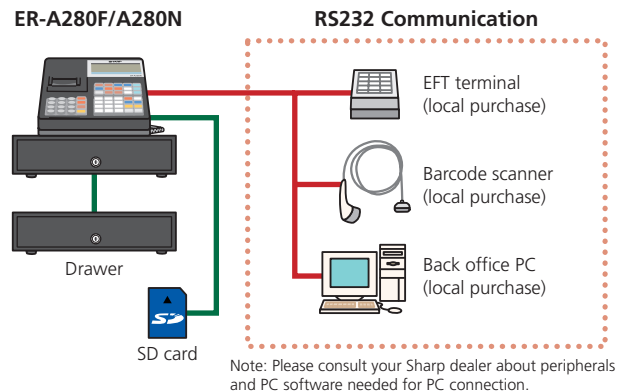

## Dimensions (mm)

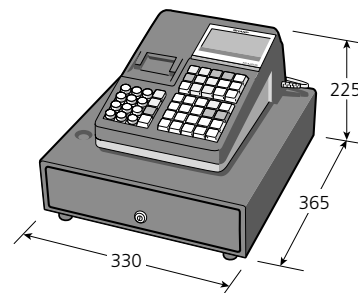

Design and specifications are subject to change without prior notice.

# SHARP



Avenida El Paso, 43 ( Los Majuelos)  
38108 - La Laguna (Tenerife) - Spain  
Telf: 922 824 810  
Fax: 34 922 824 828  
• [www.atecresa.com](http://www.atecresa.com)  
• [info@atecresa.com](mailto:info@atecresa.com)